



RESIDENTIAL ESTATE AGENTS
PROPERTY LETTING & MANAGING AGENTS
VALUERS & PROPERTY CONSULTANTS
CHARTERED SURVEYORS

01722 336422
www.hwwhite.co.uk WEB



Love Lane,

£950 PCM

122 Love Lane, Salisbury, Wiltshire, SP1 2BG



Energy Efficiency Rating		
	Current	Potential
Very energy efficient - lower running costs		
(92 plus) A		84
(81-91) B		
(69-80) C		
(55-68) D	61	
(39-54) E		
(21-38) F		
(1-20) G		
Not energy efficient - higher running costs		
England & Wales		EU Directive 2002/91/EC

A two bedroom terraced house with accommodation arranged over two floors. Door to lounge/diner, double glazed window to front. Galley kitchen leading through to rear lobby and ground floor bathroom. Bathroom with bath, electric shower over bath, basin and WC. Double glazed window to side. From the lounge/diner, stairs to first floor, lobby landing and access to both bedrooms.

Two double bedrooms to first floor.

Outside, to the rear is a small enclosed courtyard. On street parking permit available via the local authority.

Gas fired central heating, double glazing.

Ground Floor

Approx. 28.2 sq. metres (303.1 sq. feet)

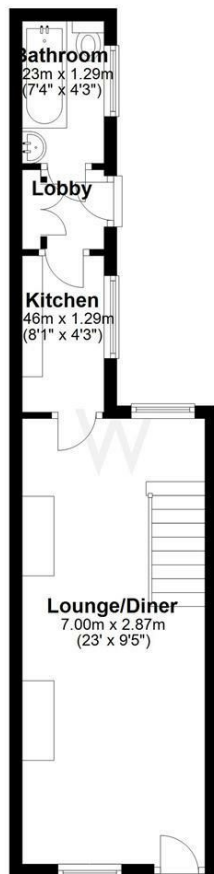

First Floor

Approx. 20.1 sq. metres (216.5 sq. feet)



Total area: approx. 48.3 sq. metres (519.6 sq. feet)



01722 336422

47 Castle Street, Salisbury SP1 3SP 01722 320600 FAX
residential-sales@hwwhite.co.uk E-MAIL www.hwwhite.co.uk WEB